

Sabbia

BEACH



ON THE OCEAN | OF THE OCEAN



PERFECTLY NATURAL

On 200 linear feet of pristine South Florida shoreline comes an extraordinary collection of luxurious residences, inextricable from their miraculous surroundings. Sabbia Beach presents a lifestyle not merely on the ocean, but of the ocean.

The beauty of the ocean inspires every aspect of Sabbia Beach, from its distinctive architectural design by the renowned Miami firm Arquitectonica, to the tasteful articulation of its interior social spaces by the prolific designers at Interiors by Steven G.



POMPANO BEACH

From the Hillsboro Inlet, an uninterrupted strand of flawless white-sand beach stretches for three miles to the south. This is Pompano Beach. The blissful breath of fresh air between the better-known communities of Fort Lauderdale and Palm Beach County.

Pompano Beach has already been recognized in the national press as one of the country's most promising and emerging real estate markets. Sabbia Beach is the proof that the promise is already becoming a reality.





EAST OCEAN VIEW

ONLY FIVE RESIDENCES PER FLOOR

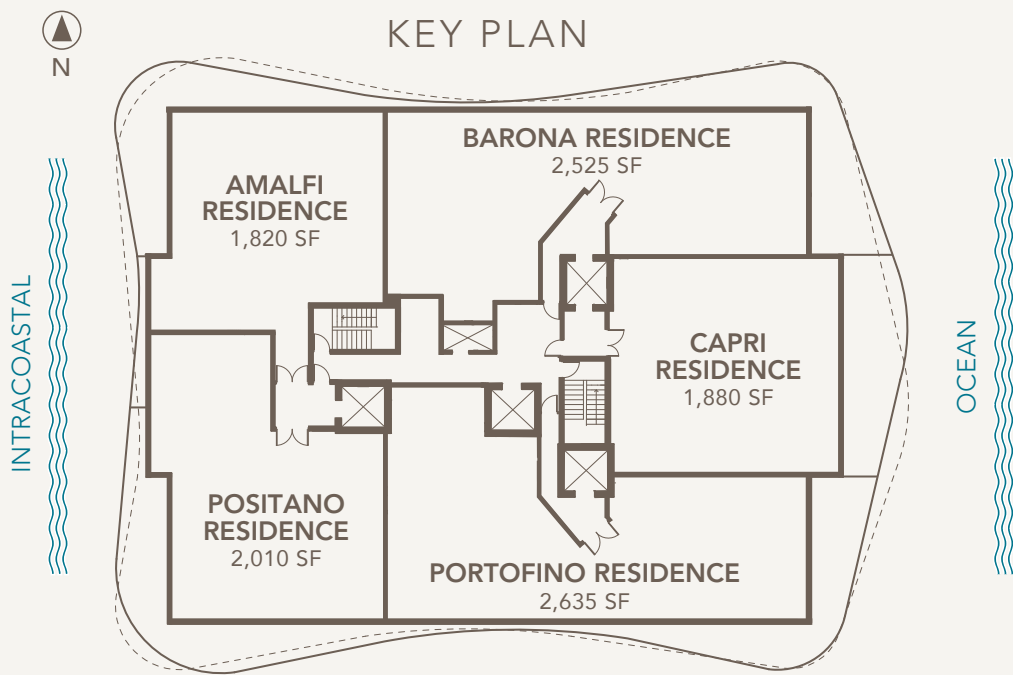

AMALFI RESIDENCE

2 BEDROOMS 2.5 BATHROOMS	
A/C AREA	1,820 SF
BALCONY	490 SF
TOTAL	
2,310 SF	

BARONA RESIDENCE

3 BEDROOMS + DEN 4 BATHROOMS	
A/C AREA	2,525 SF
BALCONY	480 SF
TOTAL	
3,005 SF	

CAPRI RESIDENCE

2 BEDROOMS + DEN 2.5 BATHROOMS	
A/C AREA	1,880 SF
BALCONY	420 SF
TOTAL	
2,300 SF	

PORTOFINO RESIDENCE

3 BEDROOMS + DEN 4.5 BATHROOMS	
A/C AREA	2,635 SF
BALCONY	480 SF
TOTAL	
3,115 SF	

POSITANO RESIDENCE

3 BEDROOMS 3 BATHROOMS	
A/C AREA	2,010 SF
BALCONY	490 SF
TOTAL	
2,500 SF	

Floor Plan measurements are approximate and are for illustrative purposes only. While we do not doubt the floor plans accuracy, we make no guarantee, warranty, or representation as to the accuracy and completeness of the floor plan. You or your advisors should conduct a careful, independent investigation of the property to determine to your satisfaction as to the suitability of the property for your space requirements.



BUILDING AMENITIES

Designed by Arquitectonica

Appointed public spaces by Interiors by Steven G.

Lush, tropical landscaping and dunes created by ArquitectonicaGEO

Stunning porte-cochere entrance

Boutique lobby with state-of-the-art security and concierge

Exotic pool deck on the ocean with beachfront vanishing-edge heated pool

Oceanfront Jacuzzi

World-class state-of-the-art fitness center with direct ocean views

Spa with treatment rooms

His and her steam rooms and saunas

3600-square-foot multipurpose social room including bar, kitchen, seating, game and poker tables and large-screen TV

Catering kitchen

Two penthouse residences with soaring, 22-foot double-height ceilings

24/7 valet parking & security

Bike storage



RESIDENCE FEATURES

Only 68 residences

Spacious floor plans

Private and semi-private elevators

Double-door entry opening to expansive views

Floor-to-ceiling windows and sliders

Generous balconies

Ocean, city and Intracoastal views

Large master suites overlooking the ocean and city

Walk-in closets in master bedroom

Freestanding soaking tubs

Gourmet kitchens with chef's island and Italian cabinetry

Stone countertops in kitchens and bathrooms

Miele kitchen appliances

Sub-Zero refrigerator

Laundry rooms with full-size washers and dryers



Sabbia

BEACH

730 NORTH OCEAN BOULEVARD,
POMPANO BEACH, FL 33062

www.sabbiabbeachcondos.com

(305) 407-1415